

A SITE DEVELOPMENT PLAN
SCALE: 1:150MTS

ILOILO SCIENCE AND TECHNOLOGY UNIVERSITY PLANNING DEVELOPMENT & AUXILIARY SERVICES BUREAU ST., LA. HAZ, ILOILO CITY	PREPARED BY: JOSE L. VIRSIKALAR JR. CIVIL ENGINEER T. I. NO.	REQUESTED AND COMPAIRED BY:	PROJECT TITLE: IMPROVEMENT OF STAIR RAILINGS	RECOMMENDING AGENCY: SAMMY A. DAITAN, D. TM OIC DIRECTOR, PWS	OIC, VP FOR ADMINISTRATION AND FINANCE: RUSS ALLEN B. NAVUD, DIT	OIC, PRESIDENT III: GABRIEL M. SALSTRE, JR., PEE, DIT	SHEET CONTENTS: DRAWN BY: DATE EXAM: DATE FINISH: REV. NO.	SHEET NO. CS 1
--	--	-----------------------------	--	--	--	---	--	------------------------------------



STAINLESS ROUND TUBE ESCUTCHEON/FLANGE (FLOOR MOUNTED FOR RAILINGS)
 (Retouching, repainting, and repairing the damaged wall/floor of the anchored railing.)



STAINLESS HANDRAIL BRACKER (WALL MOUNTED)
 VERIFY ACTUAL THE LOCATION OF STAINLESS BRACKER FOR STABILITY OF THE RAILINGS.
 (Retouching, repainting, and repairing the damaged wall/floor of the anchored railing.)

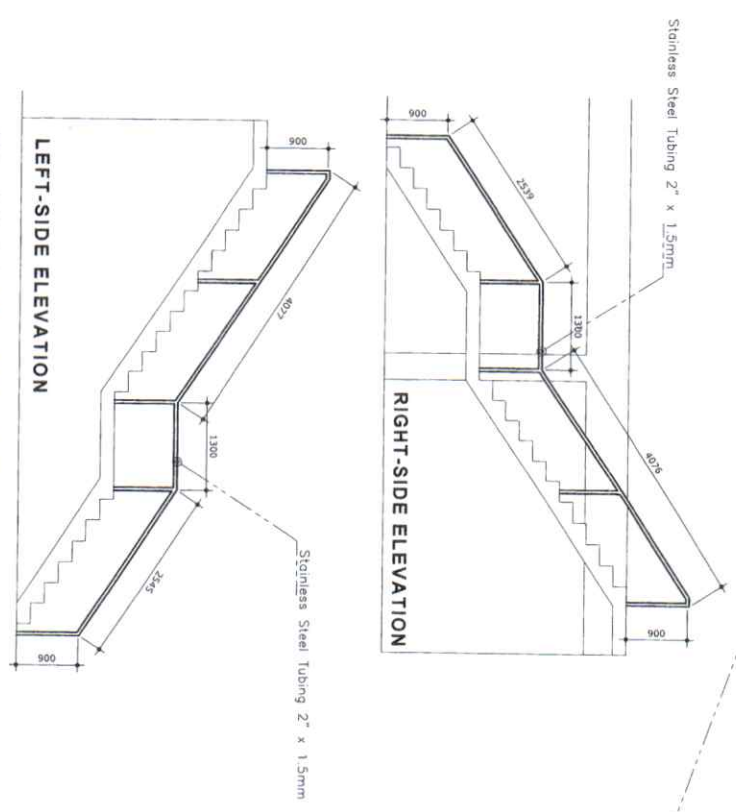

A TO ACCOUNTING STAIR ELEVATION
 SCALE: 1:100MTS

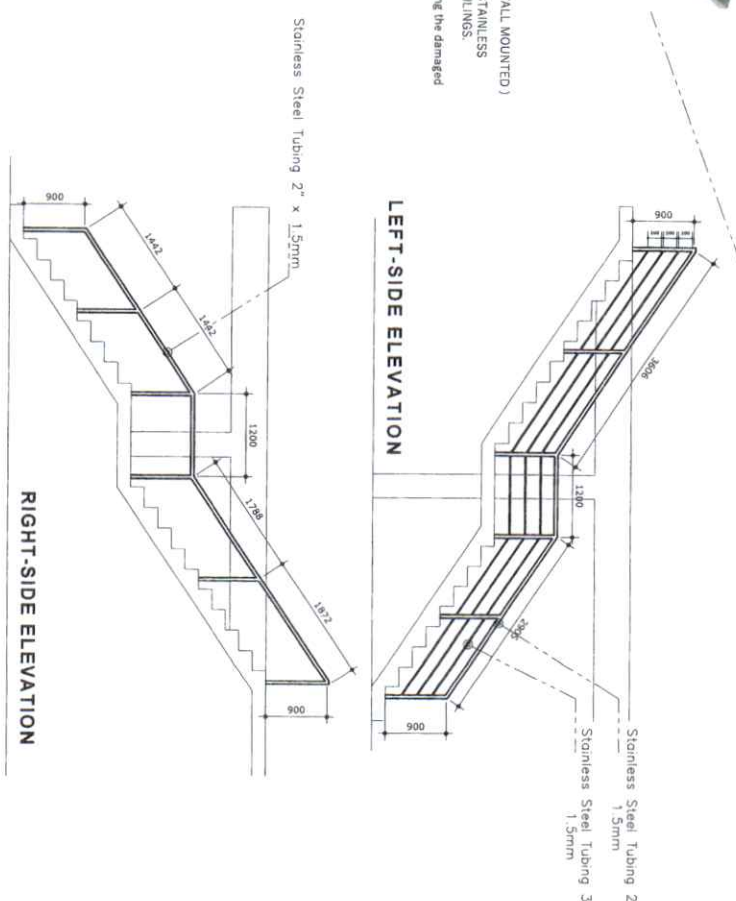

A TO 3RDFLR TVEP STAIR ELEVATION
 SCALE: 1:100MTS

DONE IN THE OFFICE OF ITOLIO SCIENCE AND TECHNOLOGY UNIVERSITY PLANNING DEVELOPMENT & AUXILIARY SERVICES BUILDING 87, LA MZ, ZOLIO CITY		PREPARED BY: JOSEPH VIRADOR JR. CIVIL ENGINEER	CHECKED BY: SAMMY A. DAMA, PH.D. DEC. DIRECTOR, POAS	RECOMMENDING APPROVAL: RUSS ALLEN B. NAVUD, DIT DEC. VP FOR ADMINISTRATION AND FINANCE	APPROVED BY: GABRIEL M. SALSTRE, JR., PEE, DIT INC. PRESIDENT III	SHEET CONTENTS: DRAWN BY: DATE DRAWN: DATE CHECKED: REV. NO.	SHEET NO. 1 3
--	--	---	---	---	--	--	-----------------------------------

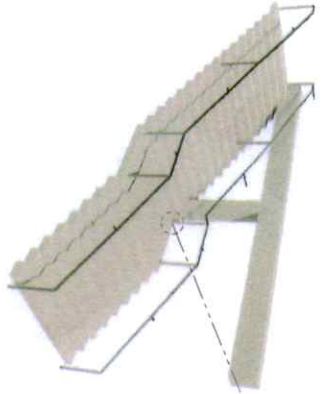

STAINLESS ROUND TUBE ESCUTCHEON/FLANGE (FLOOR MOUNTED FOR BALUSTERS)
 (Retouching, replastering, and repainting the damaged wall/floor of the anchored railing.)



STAINLESS HANDRAIL BRACKET (WALL MOUNTED)
 VERIFY ACTUAL THE LOCATION OF STAINLESS BRACKET FOR STABILITY OF THE RAILINGS.
 (Retouching, replastering, and repainting the damaged wall/floor of the anchored railing.)

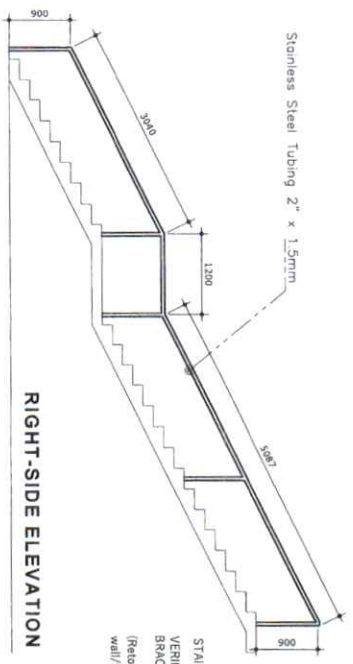
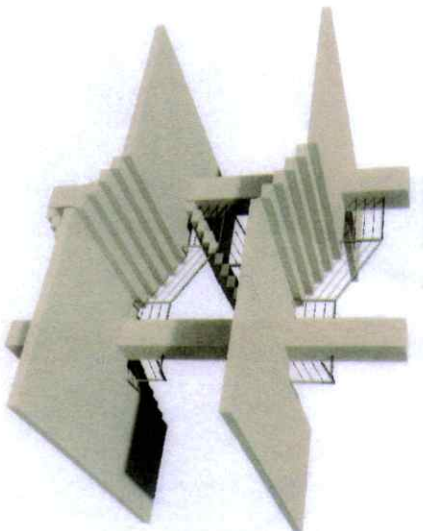
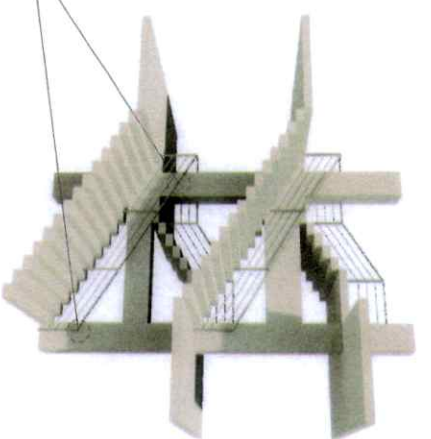

RIGHT-SIDE ELEVATION

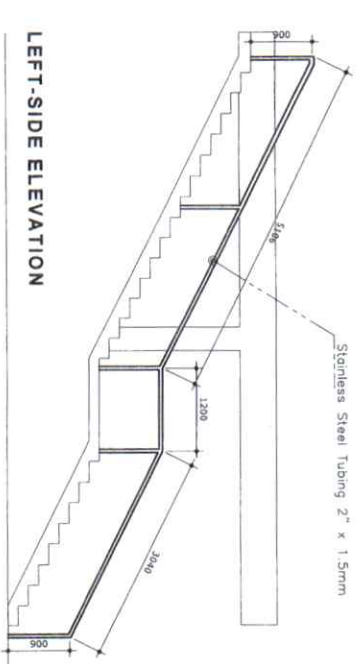

LEFT-SIDE ELEVATION

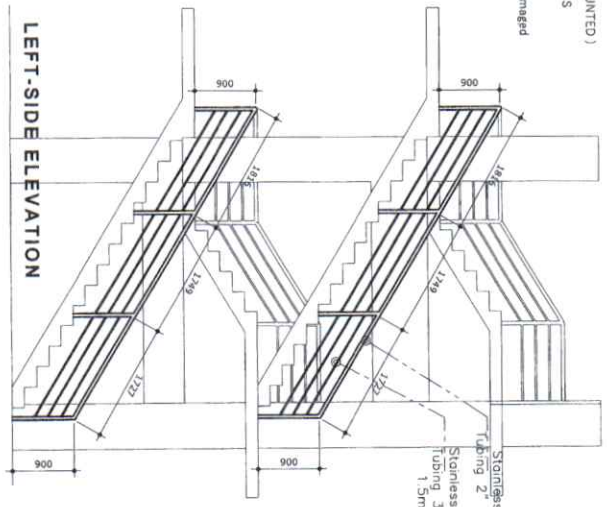

LEFT-SIDE ELEVATION

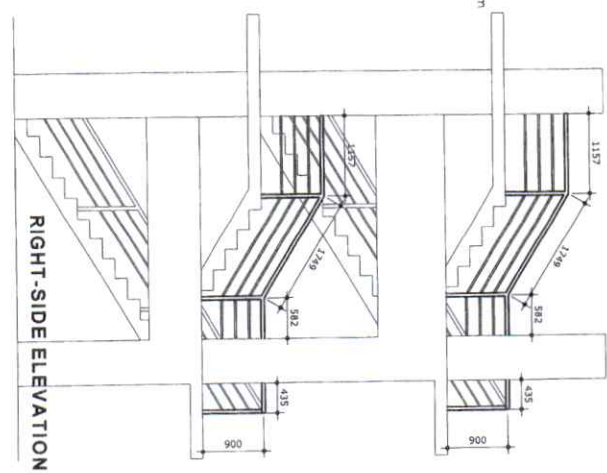

RIGHT-SIDE ELEVATION

A TO TVEP BUILDING



SCALE: 1:100M/TS

A TO GRACIANO BUILDING



SCALE: 1:100M/TS

PREPARED BY: VJSE - VIRGILIO SERRANO JR. ARCHITECT		REVIEWED AND APPROVED BY: SAMANTHA A. DAVILA, Ph.D., T.M. OAC DIRECTOR, OACB		PROJECT TITLE: IMPROVEMENT OF STAIR RAILINGS		RECOMMENDED APPROVAL: RUSS ALLEN B. M.PUD., DIT OAC VP FOR ADMINISTRATION AND FINANCE		SHEET NO.: A	
ISSUED BY: GABRIEL M. SALISTRÉ, JR., P.E., DIT OAC VP FOR ADMINISTRATION AND FINANCE		PROJECT NO.: 15-13-10		LOCATION: STAIRS, GRACIANO BUILDING		DATE: 11/15/2015		SHEET NO.: 3	
OACB IN THE OFFICE OF: ILLINOIS SCIENCE AND TECHNOLOGY UNIVERSITY PLANNING AND DEVELOPMENT & AUXILIARY SERVICES BUNDLES ST., LA PLAZA, ILLINOIS CITY									

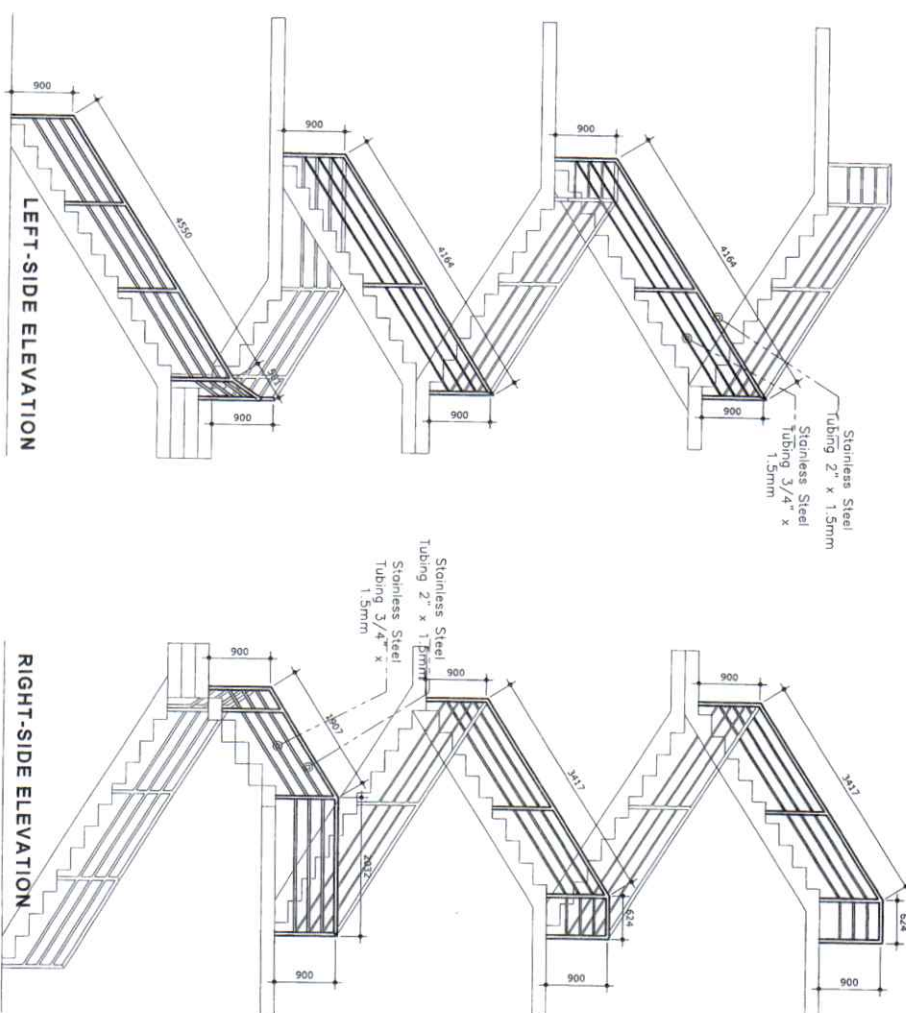

A TO GRACIANO BUILDING

SCALE: 1:100MMS

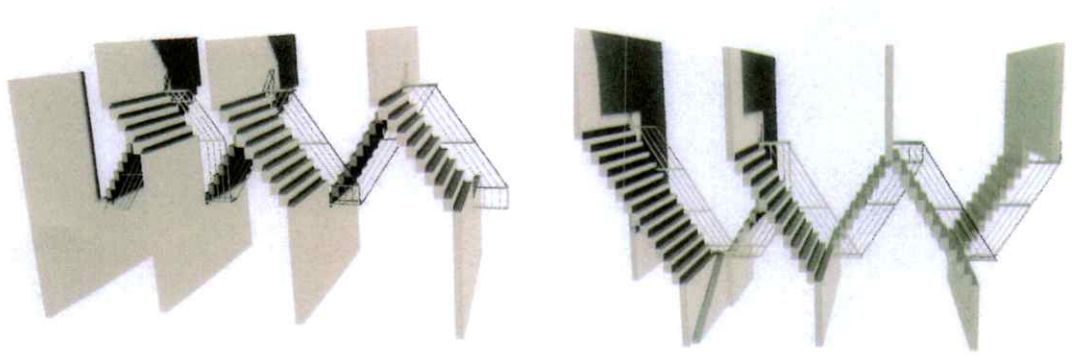

DRAWN BY: JOSE L. VIRGILIO TITLE: PLANNING DEVELOPMENT & AUXILIARY SERVICES FIRM: PLANNING DEVELOPMENT & AUXILIARY SERVICES ADDRESS: BUNDOO ST., LA PALMA, LOS BAJO CITY		PREPARED BY: JOSE L. VIRGILIO TITLE: PLANNING DEVELOPMENT & AUXILIARY SERVICES FIRM: PLANNING DEVELOPMENT & AUXILIARY SERVICES ADDRESS: BUNDOO ST., LA PALMA, LOS BAJO CITY		REQUESTED AND COMPLETED BY: IMPROVEMENT OF STAIR RAILINGS ADDRESS: BUNDOO ST., LA PALMA, LOS BAJO CITY		RECOMMENDED APPROVAL: SAAMAT A. DATON, PHA, TM OIC, DIRECTOR, PDAI		OIC, VP FOR ADMINISTRATION AND FINANCE: RUSSELL ALLEN B. NAPUD, DIT		OIC, PRESIDENT: GABRIEL M. SALISME, JR., PEE, DIT		SHEET CONTENTS: DRAWING BY: _____ CHECKED BY: _____ DATE: _____ SHEET NO.: _____		SHEET NO. A OF 3	
---	--	--	--	---	--	---	--	---	--	---	--	--	--	-----------------------------------	--

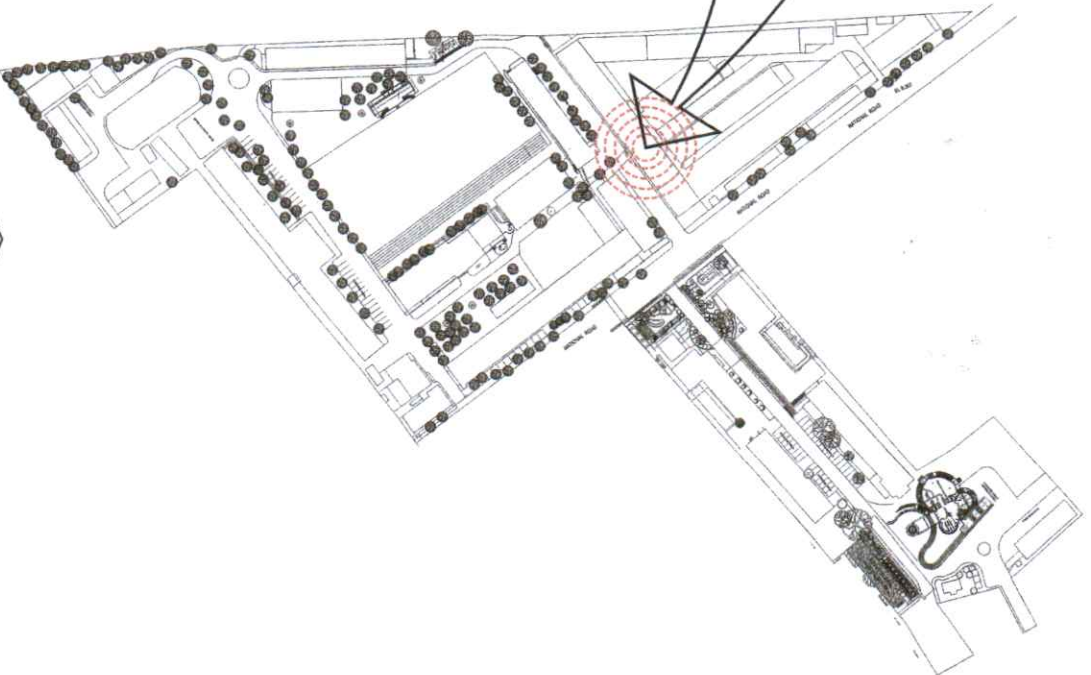
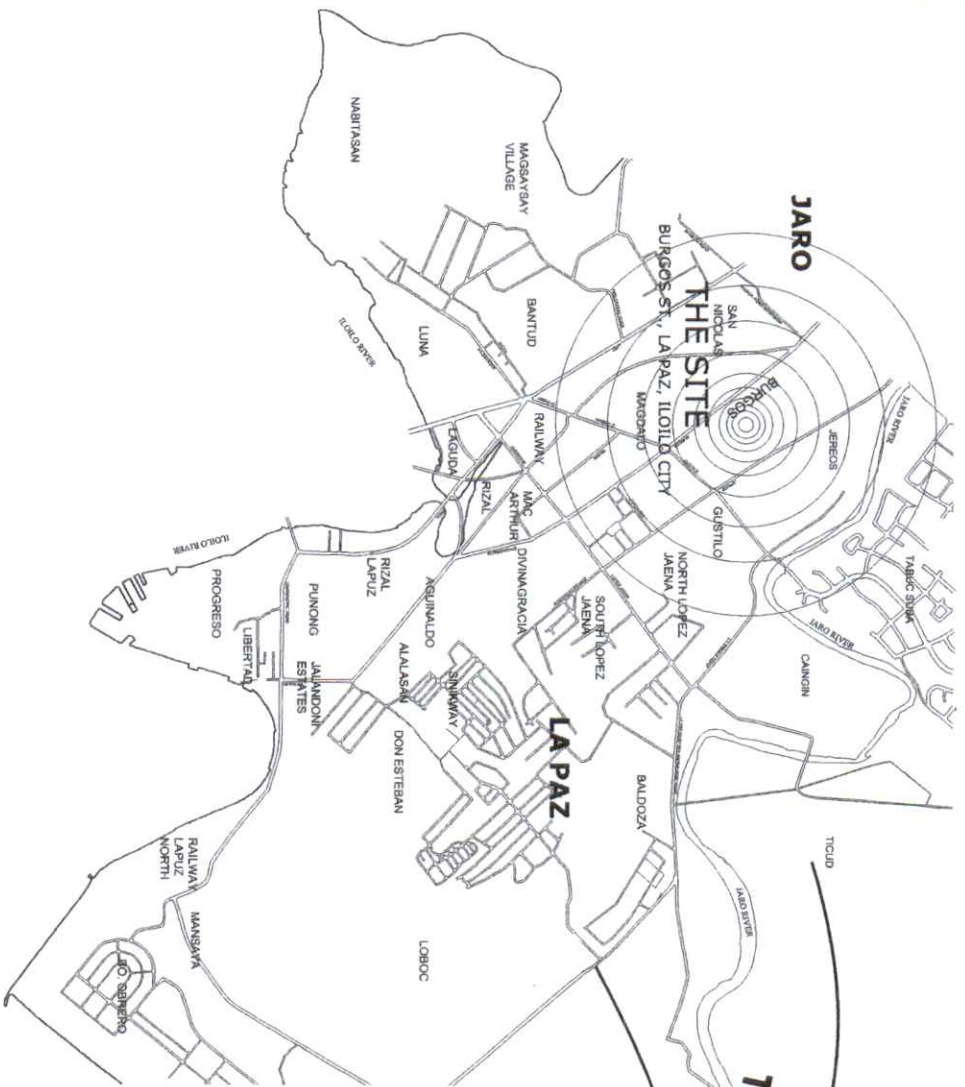

1
A 1
LOCATION MAP
SCALE: NTS



1
A 1
VICINITY MAP
SCALE: NTS

<p>ILOILO SCIENCE AND TECHNOLOGY UNIVERSITY PLANNING DEVELOPMENT & AUXILIARY SERVICES</p>	<p>DESIGN BY: <i>AR. NOWELL RON A. ARSAYO</i> PROJECT DEVELOPMENT OFFICER II PR. NO.: [] REG. NO.: []</p>	<p>NOTE: ALL DESIGN, DRAWINGS, SPECIFICATIONS & CALCULATIONS ARE THE PROPERTY OF ILOILO SCIENCE AND TECHNOLOGY UNIVERSITY. ANY REPRODUCTION OR CONNECTION WITH THE PROJECT ARE ASSUMED TO BE THE RESPONSIBILITY OF THE USER. THE USER AGREES TO BE REPRODUCED OR NOT, THEY ARE NOT TO BE REPRODUCED OR USED ON OTHER WORK EXCEPT BY THE USER.</p>	<p>PROJECT TITLE: IMPROVEMENT OF RAILINGS AT CASHIER'S QUEUING LANE AND ADMIN ENTRY WAY</p>	<p>RECOMMENDING APPROVAL: DR. SAMMY A. DAITAO DR. RUSS ALLEN B. NAPUD</p>	<p>APPROVED BY: DR. GABRIEL M. SALUSTRE, JR.</p>	<p>SHEET CONTENTS:</p>	<p>SHEET NO. 1 3</p>
	<p>DONE IN THE OFFICE OF:</p>		<p>DR. GABRIEL M. SALUSTRE, JR. DRAWN BY: [] CHECKED BY: []</p>	<p>SHEET NO. 1 3</p>			



1
CASHIER'S QUEUEING LANE
ARCHITECTS PERSPECTIVE
SCALE: NTS

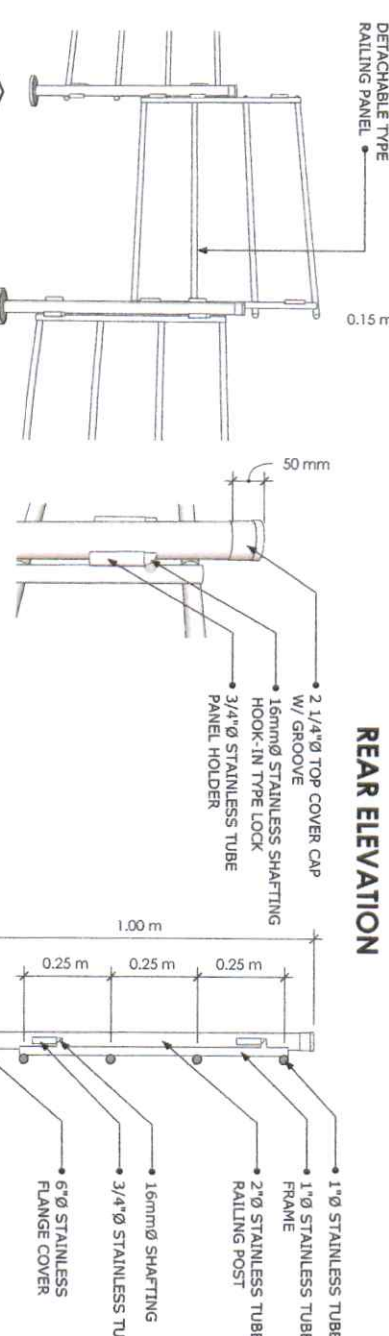
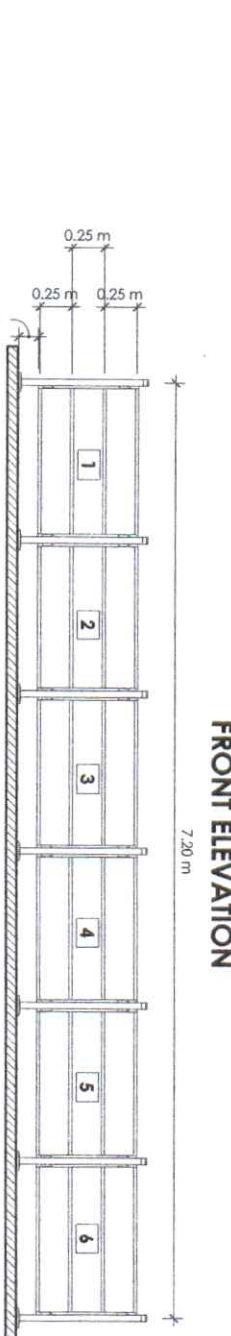
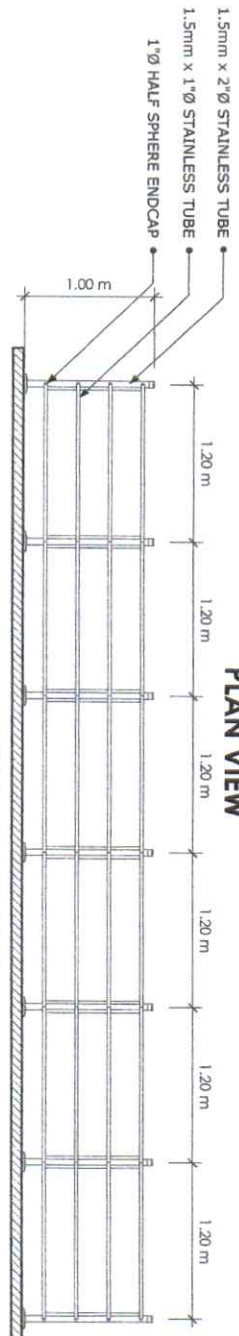
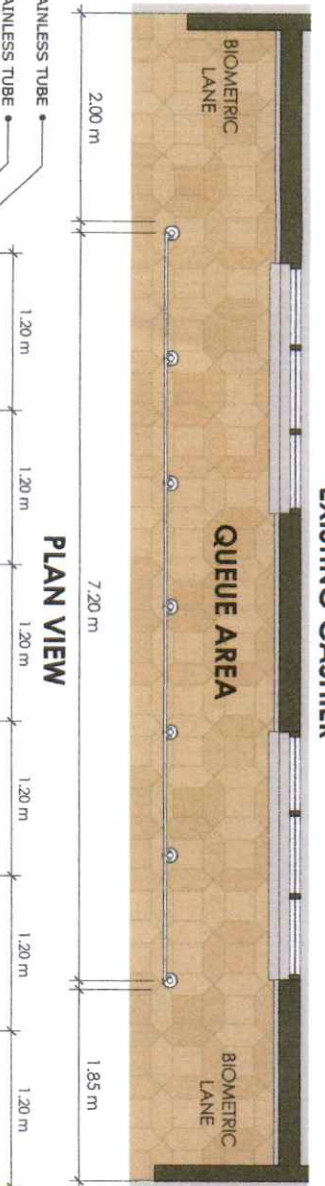

2
RAILINGS DETAIL
SCALE: 1:30 NTS

CONNECTION DETAIL

SECTION

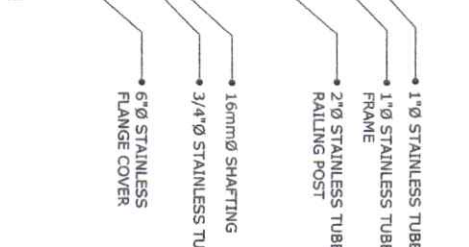

EXISTING CASHIER

DONE IN THE OFFICE OF:

LILO SCIENCE AND TECHNOLOGY UNIVERSITY
PLANNING DEVELOPMENT
& AUXILIARY SERVICES
 BIROBO, S.L.A. PAL, BIROBO CITY

DESIGN BY: *[Signature]*
PROJECT DEVELOPMENT OFFICER I
AE. MOWEL ROLA A. ARSAYO
 REG. NO.: *[Number]*

NOTE:
 ALL DESIGN, DRAWINGS, SPECIFICATIONS & CONSTRUCTION SHALL BE THE PROPERTY OF THE ARCHITECT. THE ARCHITECT'S LIABILITY IS LIMITED TO THE PROFESSIONAL SERVICE HE/FHE SHE/HE SHE REPRODUCED OR USED ON OTHER WORKS WITHOUT THE ARCHITECT'S WRITTEN AGREEMENT WITH THE ARCHITECT.

PROJECT TITLE:
IMPROVEMENT OF RAILINGS AT CASHIER'S QUEUEING LANE AND ADMIN ENTRY WAY

RECOMMENDING APPROVAL:
DR. SAMMY A. DATAO

DR. RUSS ALLEN B. NAPUD

APPROVED BY:
DR. GABRIEL M. SAUSTRE, JR.

SHEET CONTENTS:	SHEET NO.
PERSPECTIVES AND RAILING DETAILS	2
	3

DRAWN BY:
DATE:



1
3
ARCHITECTS PERSPECTIVE
SCALE: NTS

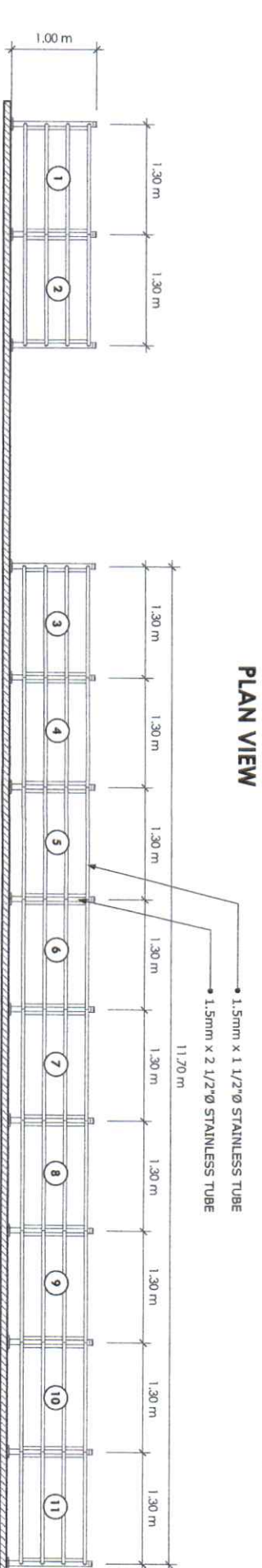

FRONT ELEVATION

DONE IN THE OFFICE OF:



ILOILO SCIENCE AND TECHNOLOGY UNIVERSITY
PLANNING DEVELOPMENT
& AUXILIARY SERVICES
BARRIOS ST. LA PAZ, ILOILO CITY

DESIGN BY: *AR. NORWEL RON A. ARSAYO*

PROJ. NO.:
DESIGN NO.:
REG. NO.:
LIC. NO.:

NOTE:
ALL DIMENSIONS, DRAWINGS, SPECIFICATIONS & COMMENTS REFERENCED & FINISHED BY THE ARCHITECT IN HIS PROFESSIONAL SERVICE. THESE ARE THE RESPONSIBILITIES OF THE ARCHITECT. WHETHER THEY ARE PROVIDED OR NOT, THEY ARE NOT TO BE CONSIDERED AS A BASIS FOR LIABILITY. THE ARCHITECT'S LIABILITY IS LIMITED TO THE SCOPE OF THE SERVICES PROVIDED AND SHALL NOT BE CONSIDERED AS A BASIS FOR LIABILITY. THE ARCHITECT'S LIABILITY IS LIMITED TO THE SCOPE OF THE SERVICES PROVIDED AND SHALL NOT BE CONSIDERED AS A BASIS FOR LIABILITY.

PROJECT TITLE:

IMPROVEMENT OF RAILINGS AT
CASHIERS QUEUING LANE AND
ADMIN ENTRY WAY

RECOMMENDING APPROVAL:

DR. SAMMY A. DAITAO
DR. RUSS ALLEN B. NAPUD

APPROVED BY:

DR. GABRIEL M. SALUSTRE, JR.

SHEET CONTENTS:

PERSPECTIVES AND RAILING
DETAILS

SHEET NO.

3